

AVI CAR CARE

Industrial

Vacuum & Air Systems

AUTO DRYER

Smarter, Stronger, Lasts Longer ... up to 70% more energy efficient



AutoDryer™ is a carwash drying system that's ultra-durable and remarkably energy efficient. Unlike traditional systems that use plastic dryer housings, AutoDryer™ features solid cast aluminum housings. This new design outlasts and outperforms the competition. In addition, the AutoDryer™ system can be equipped with DryerIQ™, an advanced power management Motor Control Center that ensures maximum energy efficiency and maximum savings.

AutoDryer™ is taking the carwash industry by storm, leaving traditional energy hogging dryer systems in the dust . . . and slashing operating costs by an average of up to 70%.

888-628-8682

email: sales@autovacinc.com



www.autovacinc.com

AutoDryer™ Features

The AutoDryer™ System dries vehicles very efficiently. The blower housing is cast aluminum which is rigid, crack-resistant and impervious to the elements. Its unique engineered casting design incorporates a scrolled housing that produces high CFM and air pressure velocities to maximize drying

performance. Our backward curved impellers are manufactured to strict standards. All AutoDryer™ Systems are built on a structurally sound blower frame made of aluminum, stainless steel or coated carbon steel. Available in 10 or 15 horsepower models. Add DryerIQ™ to maximize performance and efficiency.

Features	Benefits
Solid cast aluminum housings form a rigid no-flex design	No "Oil-Canning", rigid design holds its shape and resists cracking, dramatically longer equipment life
Larger, more efficient impeller blades	Larger air blades create greater pressure (made possible by rigid aluminum housing)
Customizable layout	Dryers can be arranged to your exact specifications, units are interchangeable for left or right mounting
Customizable color	Match your wash's color scheme
High Quality Components	Our impellers, air actuators, fasteners and hardware are designed for maximum reliability and durability
Arch assembly available in several styles	Choose a material that fits your needs: steel (with Endura paint), stainless steel, or aluminum
Nozzle are easy to change and available in 4 styles	Create the ideal air pressure and airflow where you need it

DryerIQ™

The DryerIQ™ Difference

Every AutoDryer™ system can be equipped with DryerIQ™. This proprietary power management program features highly specialized computer software and a dynamic variable frequency drive (VFD). DryerIQ™ effectively matches the RPMs of the blower's motor to match the load. DryerIQ™ does this by managing the RPMs – not just restricting air flow. This is a significant departure from traditional blower models which simply close a valve, or air brake, between cars. Closing an air brake reduces the load on a motor – BUT that motor is still running full throttle and spinning its blades at max RPMs. It does very little to combat the wear and tear on equipment, and fails to capture the remarkable energy savings made possible by DryerIQ™. (See below.)



Example: 208V Dryer Motor

	Full Throttle	Air Brake Closed (But Still Full Throttle)	Air Brake Closed with DryerIQ™
Flow in AMPS	48 Amps	24 Amps	12 Amps
RPMs – Hz (Hz x sec=RPM)	60 Hz	60 Hz	40 Hz
Kilowatts (\$ energy \$)	11 kW	9 kW	2 kW

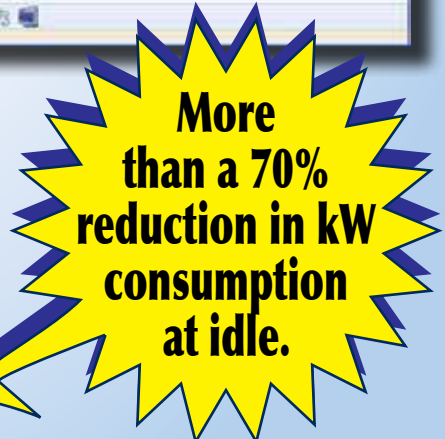

AutoDryer™ Specifications

10Hp Blower Specifications

Velocity: 160 MPH Air Speed - Air Flow: 3700 SCFM

Voltage	Hertz	Electrical	Part #
208/230/460 V	60 Hz	3 Phase	C251-1001
575V	60 Hz	3 Phase	C251-1002
415V	50 Hz	3 Phase	C251-1003
380V	50 Hz	3 Phase	C251-1004

15Hp Blower Specifications

Velocity: 185 MPH Air Speed - Air Flow: 4950 SCFM

Voltage	Hertz	Electrical	Part #
208/230/460 V	60 Hz	3 Phase	C251-1501
575V	60 Hz	3 Phase	C251-1502
415V	50 Hz	3 Phase	C251-1503
380V	50 Hz	3 Phase	C251-1504

Decibel Levels (10Hp and 15Hp)

10 Feet	85 dBA
20 Feet	79 dBA
50 Feet	72 dBA

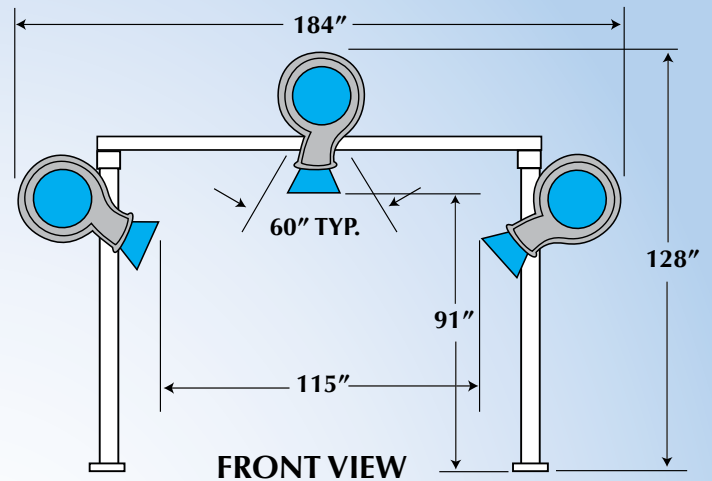

- One arch with three air producers requires 37 inches of wash tunnel length.
- Each additional arch with air producers requires an additional 46 inches of wash tunnel length.
- Models with side air producers require 185 inches of wash tunnel width.
- Models with top air producers ONLY require 131 inches of wash tunnel width.
- Models with side air producers ONLY require 108 inches of wash tunnel height.
- Models with top air producers require 134 inches of wash tunnel height.

AutoDryer™ Performance (15HP)

- Design Point ▼ Peak Pressure ▲ Power vs. Volumn

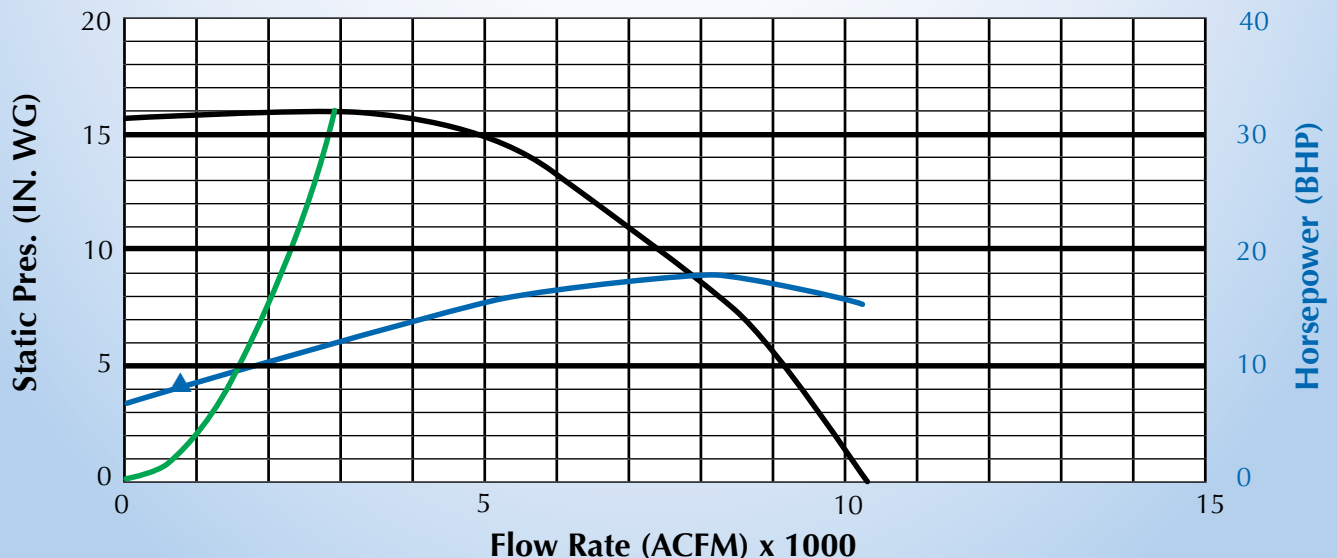

CAUTION. FAN MUST NOT OPERATE LEFT OF PEAK PRESSURE CURVE, EXCEPT FOR START-UP

AutoDryer™ Parts Breakdown

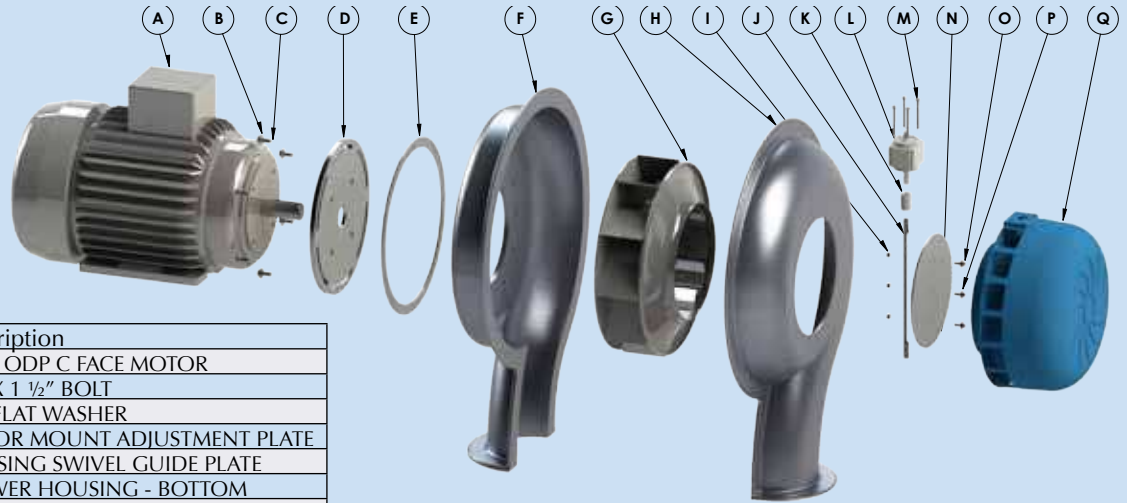

Item	Part #	Description
A	C450-0301	15Hp ODP C FACE MOTOR
B	C911-0919	3/8" X 1 1/2" BOLT
C	C911-0905	3/8" FLAT WASHER
D	C250-9121	MOTOR MOUNT ADJUSTMENT PLATE
E	C250-9120	HOUSING SWIVEL GUIDE PLATE
F	C250-9111	BLOWER HOUSING - BOTTOM
G	C250-9201	18" IMPELLER ASSY
H	C250-9112	BLOWER HOUSING - TOP
I	C911-0305	#10 LOCK NUT
J	C250-9032	AIR VALVE PIVOT ROD
K	C911-3002	1/2" COUPLER
L	C950-0006	PNEUMATIC ACTUATOR
M	C911-0722	1/4" X 3 1/2" BOLT
N	C250-9031	AIR BRAKE
O	C911-0303	# 10 FLAT WASHER
P	C911-0310	# 10 X 1" BOLT
Q	C250-9050	BLOWER INLET DOME

Adjustable Motor Mount	
Part #	Description
C251-1201	Adjustable Motor Mount



AutoDryer™ Arches

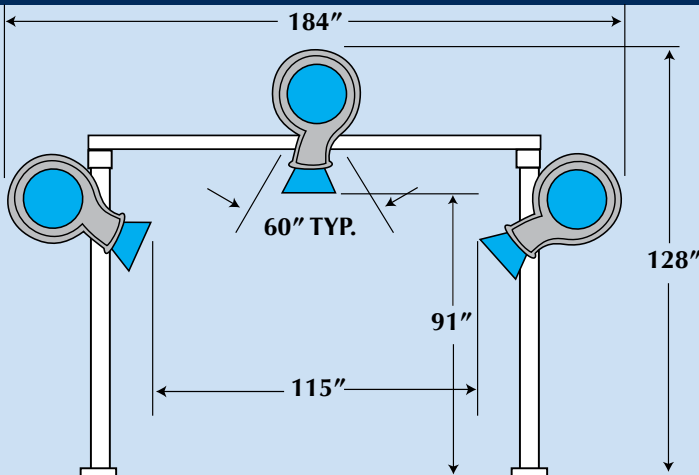

Part #	Description
C251-1101	Aluminum Arch
C251-1102	Stainless Arch
C251-1103	Carbon Steel Arch
Arch Connecting Brace 40" (Connects Multiple Arches)	
C251-1111	Aluminum
C251-1112	Stainless
C251-1113	Carbon Steel

Nozzles

Round nozzles create higher air pressure and concentrate air velocity to quickly disperse water over horizontal areas

A	C253-0011	Round Straight
B	C253-0012	Round Angled

Standard nozzles dispense higher CFM and direct airflow evenly across surfaces

C	C253-0021	Standard Straight
D	C253-0022	Standard Angled



C253-0011



C253-0012



C253-0021



C253-0022

Custom Nozzles are available.

